

### STEP 1

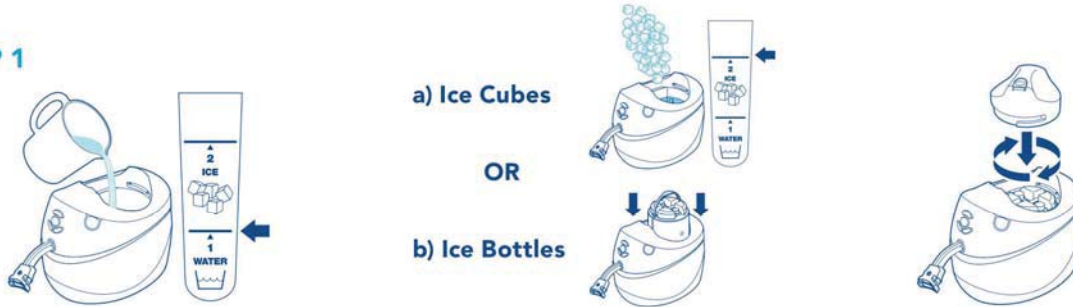

### STEP 2 Apply Compression pads to the calves.

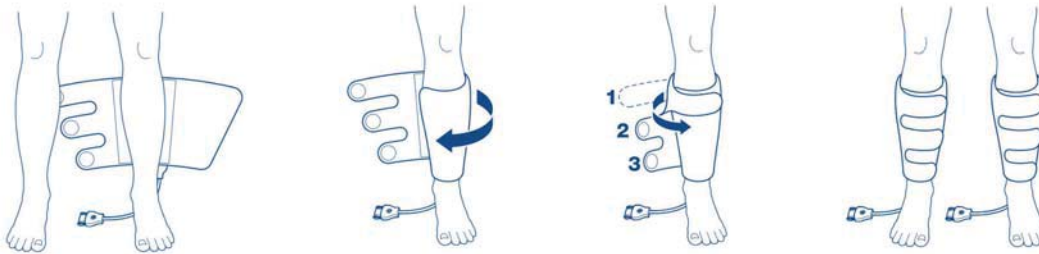

### STEP 3 Apply Cold Compression pad. (Example knee)

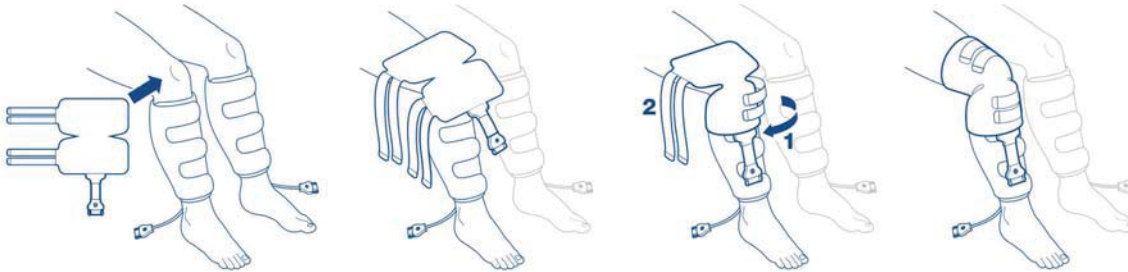

### STEP 4 Attach the Control Unit to the pads.

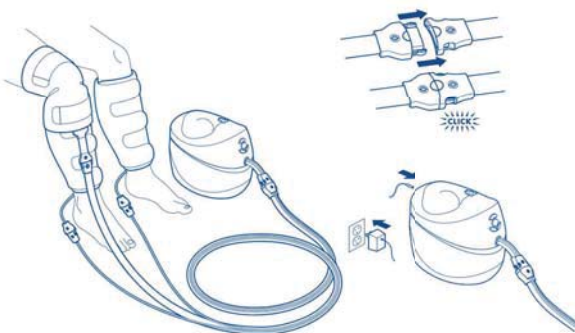

### STEP 5 Starting treatment and selecting therapies.



If you are having problems with your VPULSE unit, please contact customer care at (855) 558-7700. Please have your unit's serial number ready when dialing. This is located on the back of the unit